Stormwater Education

Are We Keeping the Water Clean?



Presented by James Gaertner, P.E., C.F.M.

Grass Clippings (What Not to Do)



Grass clippings should not be blown into the street since it will be drain into the storm system and cause the following issues:

1. Clogs storm lines and inlets



Grass Clippings (What Not to Do)



Grass clippings should not be blown into the street since it will be drain into the storm system and cause the following issues:

1. Clogs storm lines and inlets
2. Increase the nutrients in the creeks and lakes water
3. Nutrients will increase algae in lakes and kill aquatic life



Inlets



If you see an inlet that has debris or is clogged, don't wait for someone else to clean it

Go Clean that Inlet!

Inlets need to flow freely to reduce flooding



Grass Clippings



Grass clippings should:

1. Sweep or blow the grass clippings back over the grass to act as a lawn fertilizer.
2. Mulched in the lawn
3. Composted

Fertilizing



Fertilizing:

1. Follow the manufacturer's recommendation for fertilizing.
2. Don't fertilize if there is rain forecasted within 24 hours
3. Over fertilizing and fertilizing just before a rain event will drain into the storm system and creeks causing the algae to grow and killing aquatic life.

Also is just a waste of money

Swimming Pools



Draining swimming pools into the storm system is a source of pollutants into the Town's storm system.

In example, chlorine will kill aquatic life and backwash will drain debris into the Town's storm system.

Swimming Pools



To Reduce Pollutants into the Town's Storm System:

1. Swimming water to be dechlorinated before it discharges into the town's storm system or ditches.
2. Drain the backwash in an area that the debris can be collected and disposed properly.

Illicit Discharge or Illicit Connections



If you see an illicit discharge contact the Town Hall immediately.

Illicit Discharge includes:

- Discharge of mechanical fluid or chemicals in the storm system, ditches, creeks
- Swimming pool backwash and chlorinated water
- Washing machine effluent
- Sanitary sewer connection to storm system
- Private storm connections to Town's storm system



Illicit Discharge - Call Town Hall



Questions?



Chinn Chapel Bridge – Gabion Option

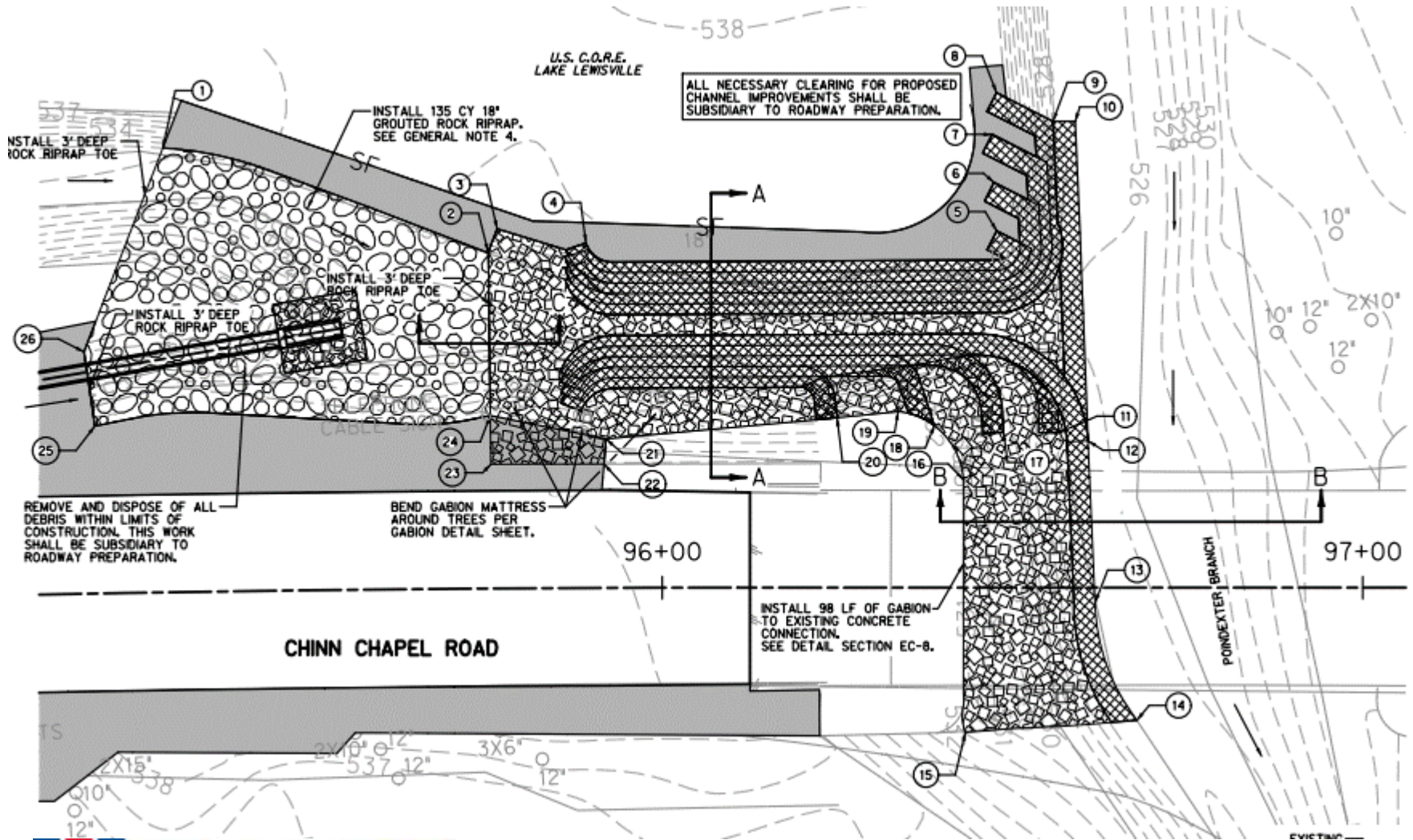

Chinn Chapel Bridge – Gabion Option

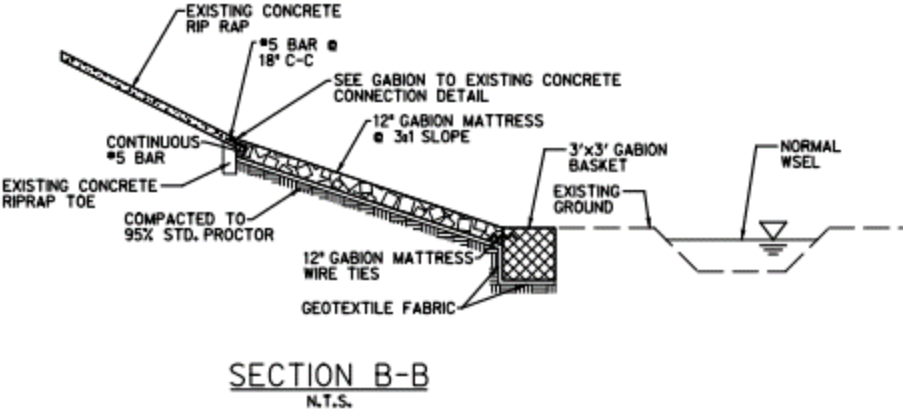
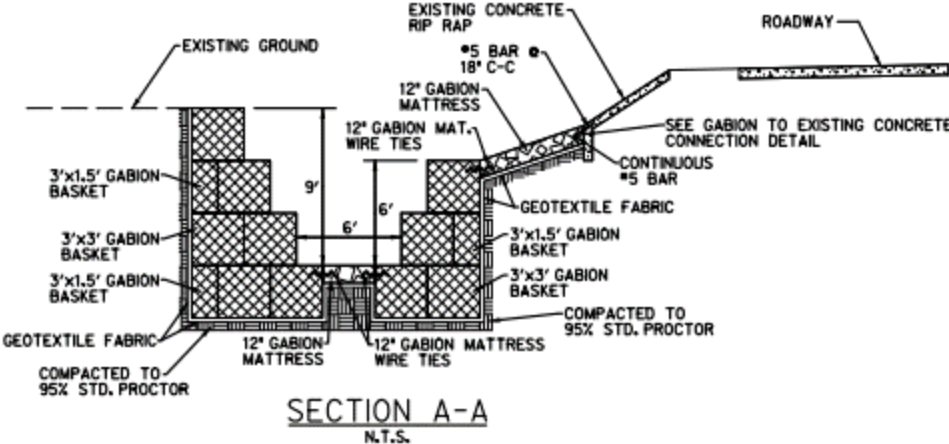

Chinn Chapel Bridge – Alternate Option

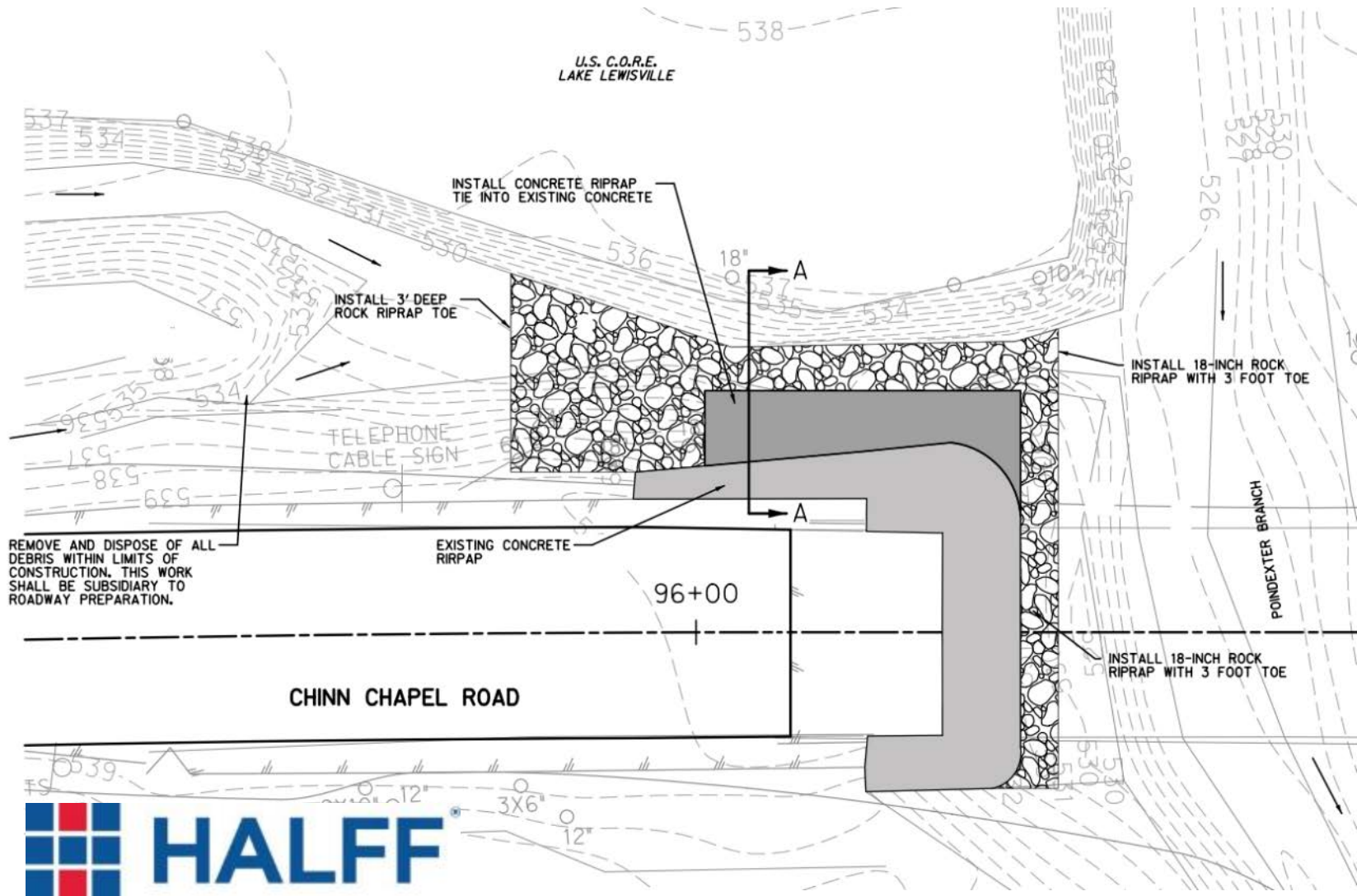

Chinn Chapel Bridge – Alternate Option

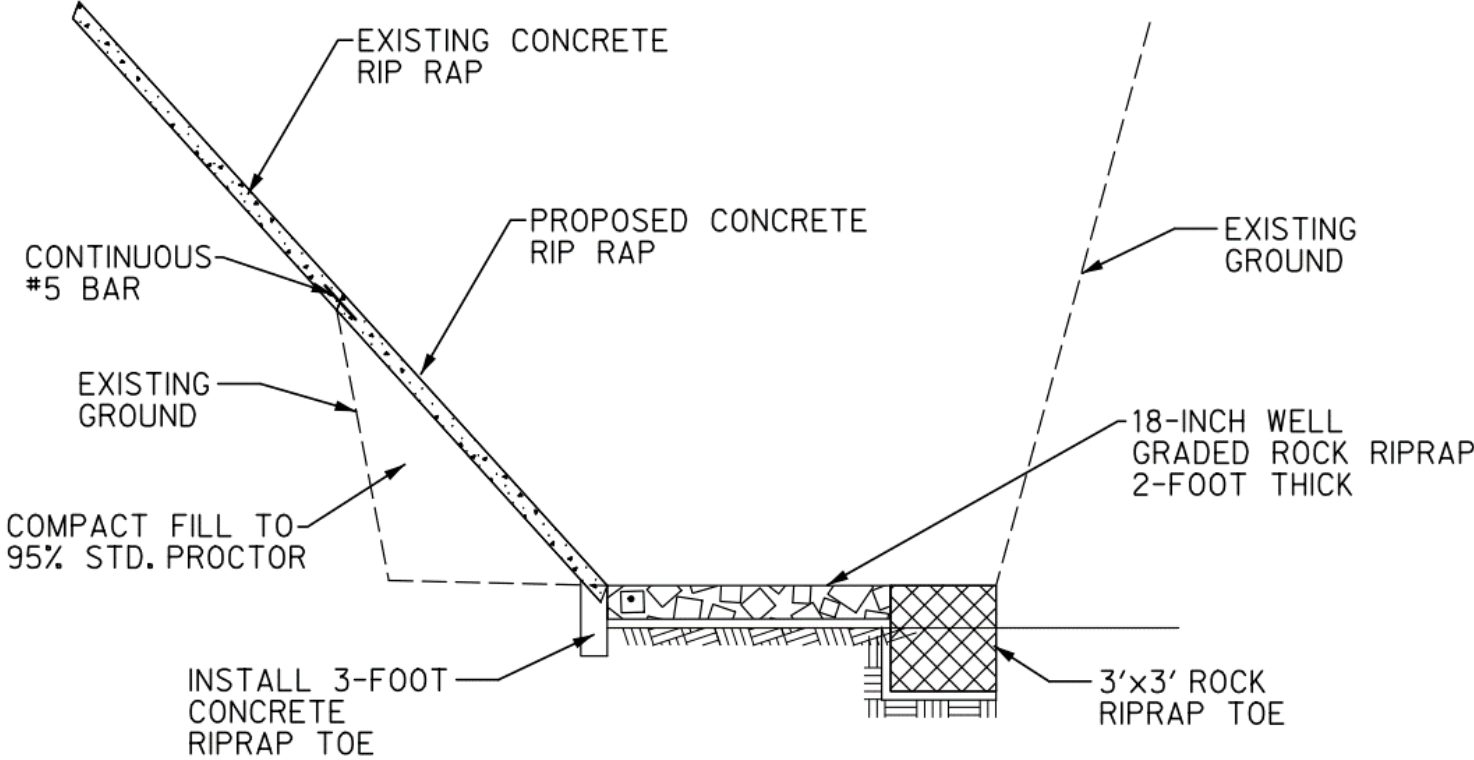

SECTION A-A
N.T.S.

